

# Soils Map

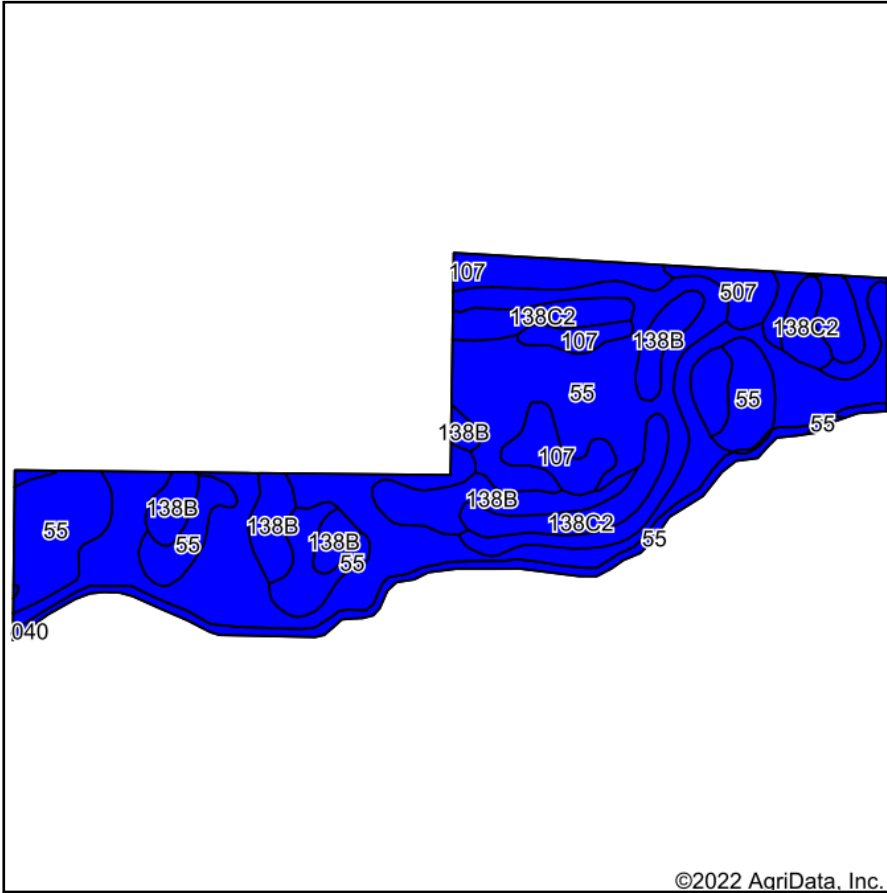

Soils data provided by USDA and NRCS.

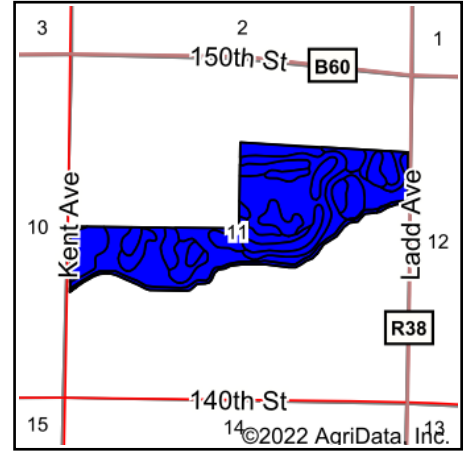

State: **Iowa**  
 County: **Hancock**  
 Location: **11-94N-25W**  
 Township: **Amsterdam**  
 Acres: **134.33**  
 Date: **10/10/2022**



Area Symbol: IA081, Soil Area Version: 32

Code	Soil Description	Acres	Percent of field	CSR2 Legend	Non-Irr Class *c	CSR2**	CSR	*n NCCPI Soybeans	
107	Webster clay loam, 0 to 2 percent slopes	51.31	38.2%		llw	86	83	82	
55	Nicollet clay loam, 1 to 3 percent slopes	49.00	36.5%		lw	89	88	82	
138B	Clarion loam, 2 to 6 percent slopes	20.29	15.1%		lle	89	80	84	
138C2	Clarion loam, 6 to 10 percent slopes, moderately eroded	11.08	8.2%		llle	83	64	73	
507	Canisteo clay loam, 0 to 2 percent slopes	2.65	2.0%		llw	84	78	81	
<b>Weighted Average</b>						<b>1.72</b>	<b>87.3</b>	<b>82.7</b>	<b>*n 81.5</b>

\*\*IA has updated the CSR values for each county to CSR2.

\*n: The aggregation method is "Weighted Average using all components"

\*c: Using Capabilities Class Dominant Condition Aggregation Method

Soils data provided by USDA and NRCS.